



LOAD-MASTER *LITE*

Tension Load Cell

Load Ranges 1000kg to 4750kg

Fits standard shackle sizes

Cabled (*LML-C*) or Wireless (*LML-W*) Options

LOAD MONITORING • FORCE MEASUREMENT • WEIGHING

Load Ranges	1000 , 2000 , 3250 , 4750	kg
Display Units	kg (other units on request)	
Battery Life	250 Hours min. (continuous)	
Wireless Range	100 Metres	(line of sight)
Accuracy Class	0.25 %	(% Applied Load)
Overload Capacity	150 %	(% Capacity)
Safety Factor (Ultimate Load)	5 : 1	
Operating temp.	0 to +50 °C	
Environmental Sealing	IP54	to BS EN60529

Included :

LML-C: Load Cell, Display, 10M Cable, Carry Case

LML-W: Load Cell, Display, Carry Case

Display Division:

1000kg	x	0.5kg
2000kg	x	1kg
3250kg	x	1kg
4750kg	x	1kg

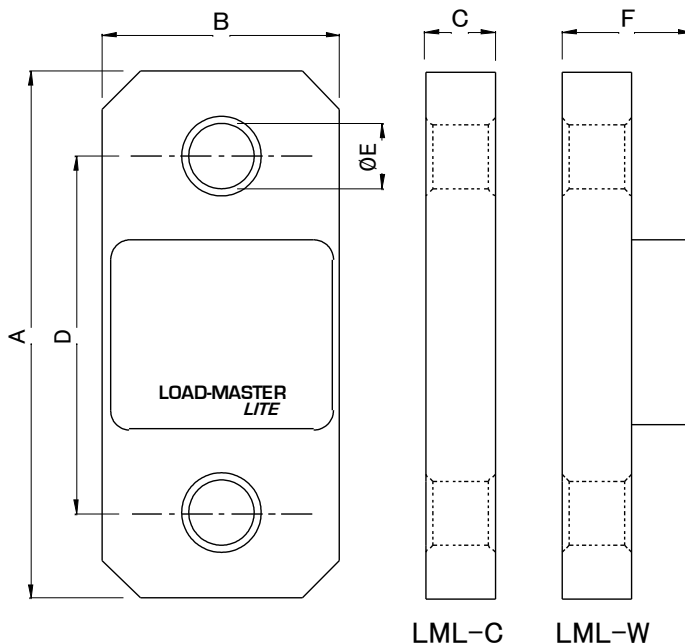

Range	A	B	C	D	ØE	F
1000	140	63	18.5	95	17	31
2000	140	63	18.5	95	17	31
3250	148	63	24	95	20	36
4750	148	63	27	95	24	40
kg						mm

Options Available:

- Analogue / Digital load cells
- Custom instrument packages
- Multi-channel systems

The information provided is intended for product description only. Specifications are subject to change. Full product details available on request.

FORCE LOGIC UK LTD
 Unit 9 Brookside Business Centre
 Swallowfield, Berkshire, RG7 1TH, UK
 T: +44 (0)118 988 8807
 E: sales@force-logic.co.uk
 W: www.force-logic.co.uk

Force
LOGIC UK

MANUFACTURED IN THE UK 