



# LOAD-MASTER LM

## Tension Load Cell

Load Ranges 2.5t to 300t

Lightweight Aluminium Alloy

Cabled (LM-C) or Wireless (LM-W) Options

### LOAD MONITORING • FORCE MEASUREMENT • WEIGHING

Load Ranges	2.5 , 5 , 12 , 25 , 50 , 100 , 200 , 300	tonne
Display Units	tonne (other units on request)	
Battery Life	100 Hours min.	
Wireless Range	100 Metres (line of sight)	
Maximum Error	0.25 %	% Reading
Overload Capacity	200 %	% Capacity
Safety Factor	5 : 1	
Operating temp.	0 to +50	°C
Environmental Sealing	IP65	to BS EN60529

Range	A	B	C	D	ØE
2.5 , 5	250	95	35	170	27
12	290	101	50	180	48
25	320	127	55	200	55
50	430	152	75	250	76
100	600	265	100	320	100
200	700	325	150	350	146
300	800	375	200	420	162

tonne mm

**Includes :**

LM-C: Load Cell, H100 Remote Display, 10M Cable, Carry Case

LM-W: Load Cell, HS-FL Remote Display, Carry Case

**Display Division:**

2.5 , 5 tonne	1kg
12 tonne	5kg
25 tonne	10kg
50 tonne	10kg
100 tonne	100kg
200 tonne	100kg
300 tonne	200kg

**Shipping Weight:**

2.5 , 5 tonne	6kg
12 tonne	7kg
25 tonne	9kg
50 tonne	12kg
100 tonne	40kg
200 tonne	85kg
300 tonne	140kg

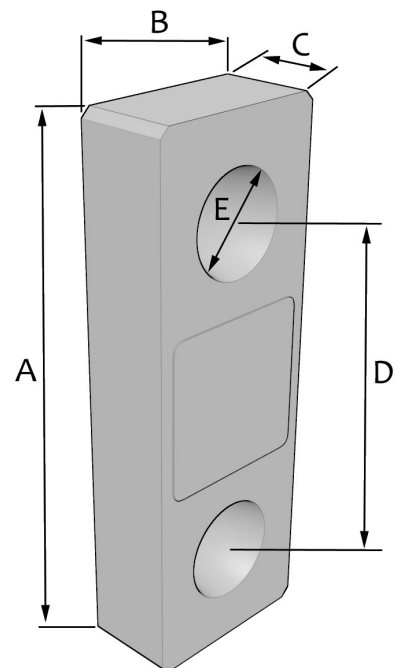

The information provided is intended for product description only.  
Specifications are subject to change.  
Full product details available on request.

**FORCE LOGIC UK LTD**

Unit 9 Brookside Business Centre  
Swallowfield, Berkshire, RG7 1TH, UK  
T: +44 (0)118 988 8807  
E: sales@force-logic.co.uk  
W: www.force-logic.co.uk

**Force**  
**LOGIC** UK

MANUFACTURED IN THE UK

